

# NSL7300

## Hennessey™ Metallic Strap Locks

GUITAR PARTS

### FEATURES AND BENEFITS

Jump! Swing your guitar! Be alive on stage! Push your axe in any direction and your strap will always remain locked on to your guitar. The Hennessey™ Strap lock, with its safe & easy-compress and release-action system, allows for easy removal of your strap and for a secure connection every time! We offer the strap locks in six different finishes.



### Easy-to-Use Installation Instructions

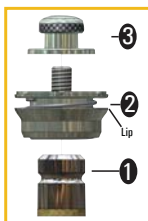

1. Unscrew the strap pin that came with your guitar.
2. Remove the pin (1) from the lock (2).
3. Screw the Hennessey™ pin and felt washer (1) on the guitar.
4. Remove the fastening nut (3) from the back (2).
5. Slide the lock (2) through the hole on your strap.
6. Take the fastening nut (3), insert into the lock (2). Hold the lock by its lip (2) and tighten to the fastening nut (3).



**COLOR Packaging!**

*Our award-winning packaging is eye-catching and acts as a "silent salesperson" describing all of the features of the product.*

### PRODUCT SPECIFICATIONS

- > **Construction:** Anodized Aluminum
- > **Colors:** Black, Purple, Gun Metal Gray, Silver, Blue & Red

**Black Strap Lock**  
 Model#: NSL7300B  
 Inv#: 51674  
 List Price: \$33.99

**Silver Strap Lock**  
 Model#: NSL7300SL  
 Inv#: 51677  
 List Price: \$33.99

**Purple Strap Lock**  
 Model#: NSL7300PV  
 Inv#: 51675  
 List Price: \$33.99

**Blue Strap Lock**  
 Model#: NSL7300BL  
 Inv#: 51678  
 List Price: \$33.99

**Gun Metal Strap Lock**  
 Model#: NSL7300GM  
 Inv#: 51676  
 List Price: \$33.99

**Red Strap Lock**  
 Model#: NSL7300R  
 Inv#: 51679  
 List Price: \$33.99

**NOTE: PACKAGED AND SOLD IN PAIRS**

Call The Music People today to place your order

# 1-800-289-8889

Visit us on the web @ [www.musicpeopleinc.com](http://www.musicpeopleinc.com) or [www.onstagestands.com](http://www.onstagestands.com)

On-Stage Stands® is a registered trademark of The Music People Inc. Prices and Specifications subject to change.



**HENNESSEY**  
GUITAR PARTS